

IBS Flow Control Penstocks

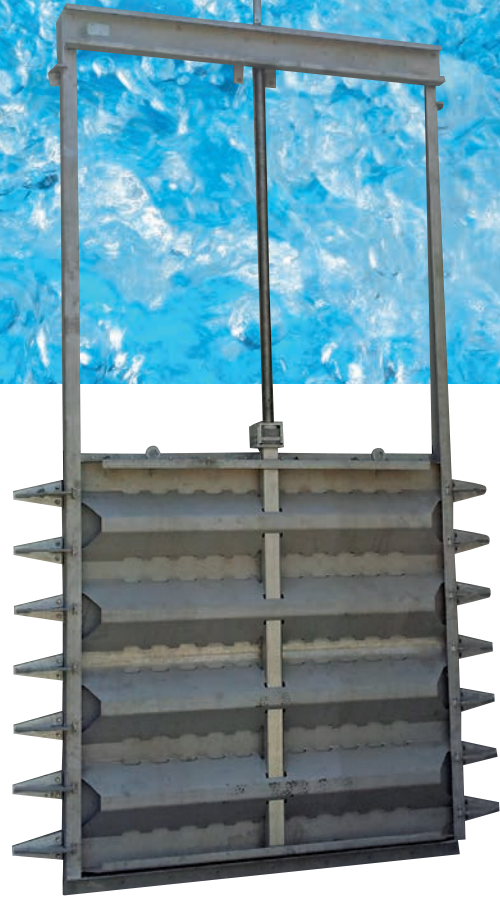

- › Vast Product Range
- › Standard Solutions
- › Use In New and Existing Structures
- › Competitive Series Production
- › Extensive Experience



Penstock

Our Products

Penstock Technique

Penstock Types

- IBS-RPS Penstock
- IBS-RPS Channel Penstock
- IBS-RPS Weir Penstock

Our Experience – Your Advantage

- Qualified
- Knowledgeable
- Reliable
- Flexible
- International

Quality Standards

- DIN
- BSI
- AWWA
- EN 1090 Certification
- Welder Certification

Sizes

- Widths: from 200 mm to 3000 mm
- Heights: from 200 mm to 4000 mm
- Water Heads: from 0.2 to 2.5 bar

Area of Application

- Waste Water Treatment Plants
- Industrial Effluent Plants
- Canals / Waterways
- Flood Defence
- Retention Tanks
- Pumping Stations
- Hydro Power Plants
- Drinking Water Plants
- Sea Water Intakes



Channel Penstock



Weir Penstock

Channel Penstock



Materials

Materials

- › Stainless Steel Grade SS304
- › Stainless Steel Grade SS316
- › Seals EPDM (Waste Water Resistant)
- › Seals Elastosil (KTW / WRAS Approved)
- › Further Materials available upon Request

Operations

Manual

- › Cap Top with T-Key
- › Handwheel
- › Gearbox

Electric Actuated

- › Electric Actuator without Control
- › Electric Actuator with Gearbox
- › Electric Actuator with Control

Cylinder Pistons

- › Pneumatic Actuator
- › Hydraulic Actuator

Cap Top with T-Key

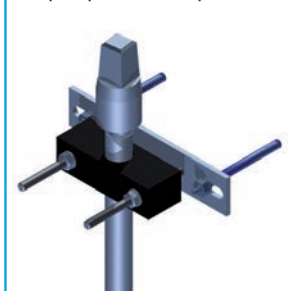

Handwheel



Gearbox



Electric Actuator



Pneumatic Actuator



Hydraulic Actuator

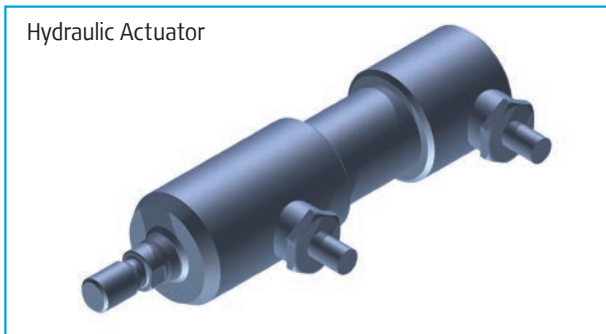

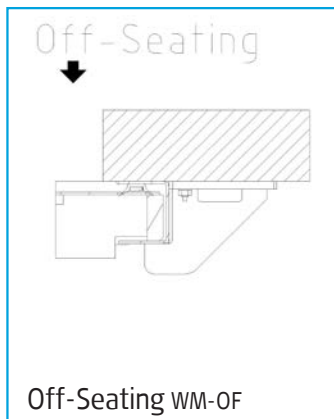
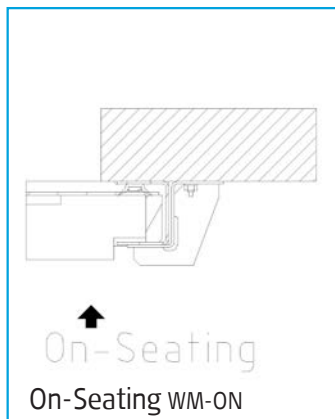

Mounting Types

Side Frame Mounting Types

Wall Mounted

- On-Seating (WM-ON)
- Off-Seating (WM-OF)

Channel Mounted

- In Rebate (CR)
- Channel Side Wall Mounted (CS)

Invert Frame Mounting Types

- In Rebate
- Wall Mounted
- Floor Mounted

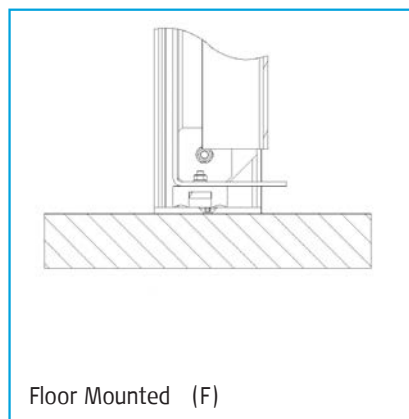
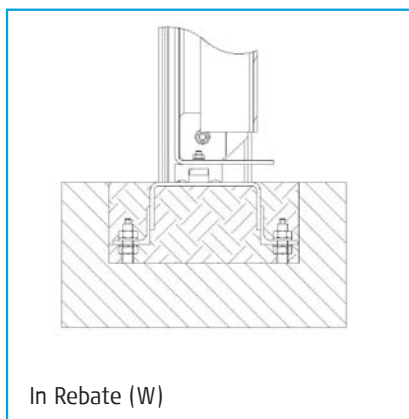
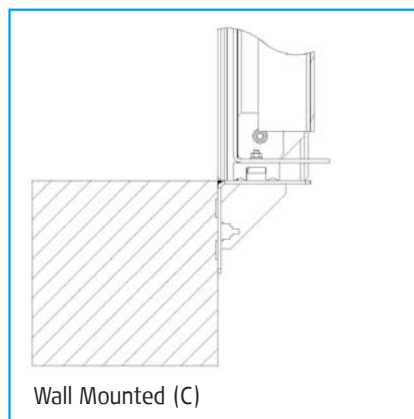
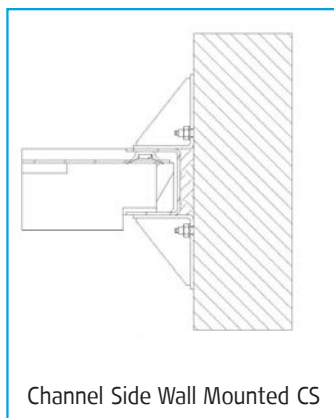
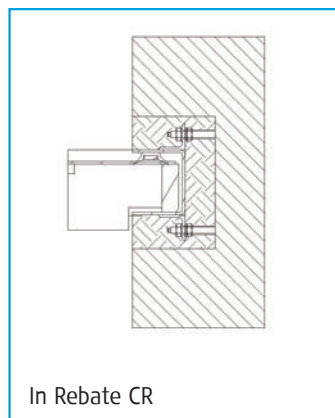



Accessories

Pedestals

- Floor Mounted
- Wall Mounted

Brackets

- Floor Brackets
- Wall Brackets
- Spindle Guide Brackets
- Frame Mounting Brackets T2, T9, T12, T15
- Channel Side Wall Brackets T1, T2

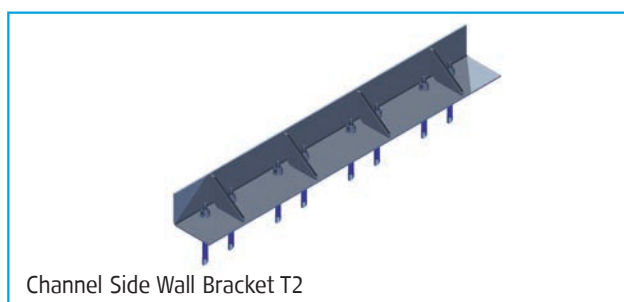
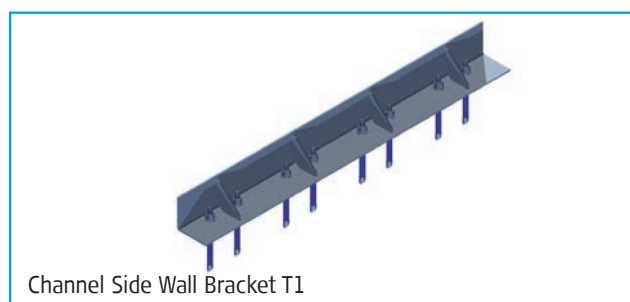
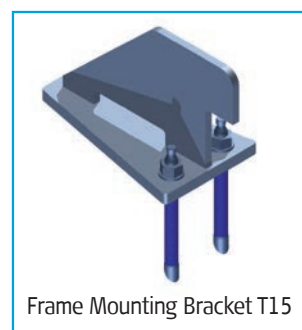
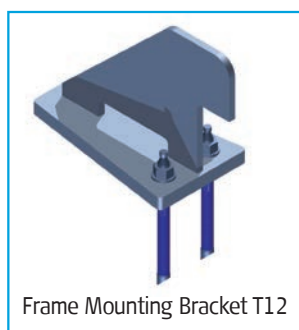
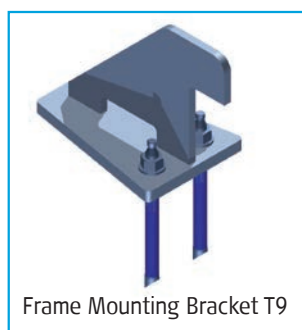
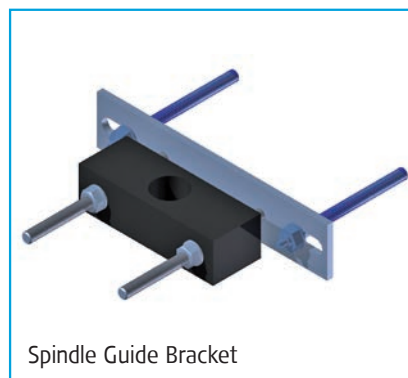
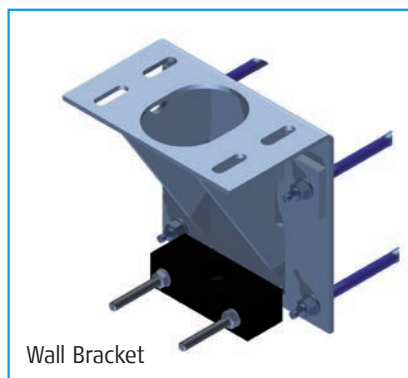
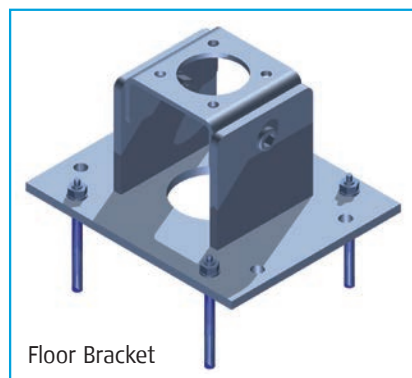
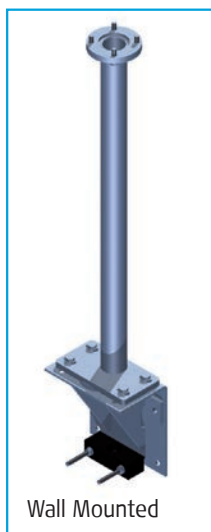
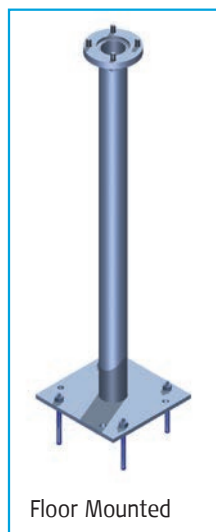



بیسارایزن پارس

نمایندگی ایران

تلفن تماس : ۸ و ۸۸۳۲۴۹۳۷ - ۰۲۱

E-mail : sales@brp.co.ir

IBSI GROUP

WWW.IBS-TECHNICS.DE

IBS Technics GmbH

Gemeindewald 6 · 86672 Thierhaupten · Germany

Tel.: + 49 (0) 8271 8176-0 · Fax: + 49 (0) 8271 8176-76

Mail: info@ibs-technics.de · Web: www.ibs-technics.de

IBS GROUP

Our Production Facilities

- IBS Technics GmbH Thierhaupten
- IBS Technics s.r.o. Rotava
- IBS Engineered Products Ltd. Barnsley

About Us

- International Engineering Company
- 150 employees
- 11,000 m² manufacturing facilities
- global leader for mobile flood water protection
- more than 4000 successfully completed projects

Our Performance

- Global distribution
- Development, design and construction
- State of the art production
- Modern machinery
- International service structure

Our Markets

- Europe
- Middle East
- North America
- Australia
- Asia

IBSI GROUP

WWW.IBSENGINEEREDPRODUCTS.CO.UK

Unit 7 · Longfields Court · Middlewoods Way

Wharnccliffe Business Park · Carlton, Barnsley · S71 3GN

Phone: +44 1226 6300-15 · Fax: +44 1226 6300-14

info@ibsengineeredproducts.com · www.ibsengineeredproducts.co.uk