

# SIEMENS

## Product data sheet

**3RF2170-1AA02**

SEMI-COND. RELAY 3RF2 WIDTH 70 A 24-230 V /  
24 V DC SCREW TERMINAL

### General details:

Product designation	solid-state relays
Product function	zero-point switching
Product designation / _1 / of the accessories that can be ordered	terminal cover
Manufacturer article number / _1 / of the accessories that can be ordered	3RF2900-3PA88

### Control circuit:

Type of voltage	DC
Control supply voltage	
• for DC / rated value / minimum	15 V
• for DC / rated value / maximum	24 V

### Main circuit:

Number of NO contacts / for main contacts	1
Operating current	
• at AC-1 / at 400 V / rated value	70 A
• at AC-51 / rated value	70 A
Operating voltage	
• at 50 Hz / for AC / rated value / minimum	24 V

• at 50 Hz / for AC / rated value / maximum	230 V
• at 60 Hz / for AC / rated value / minimum	24 V
• at 60 Hz / for AC / rated value / maximum	230 V
Connection type:	
Design of the electrical connection / for main current circuit	screw-type terminals
Design of the electrical connection / for auxiliary and control current circuit	screw-type terminals
Mechanical design:	
Type of fixing/fixation / Series installation	Yes
Width	22.5 mm

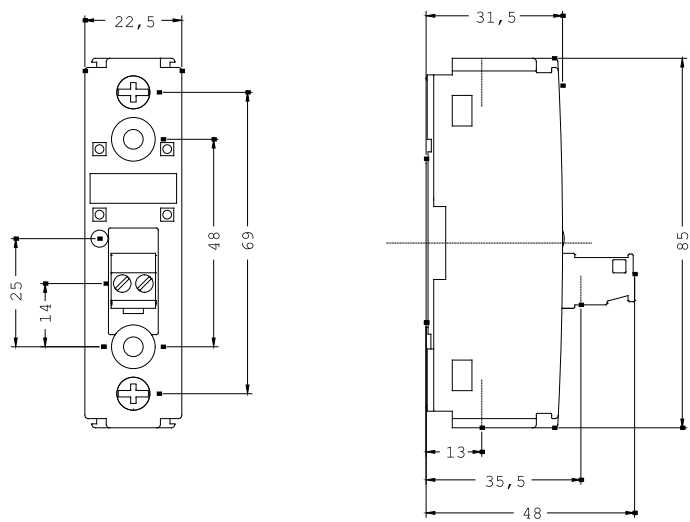

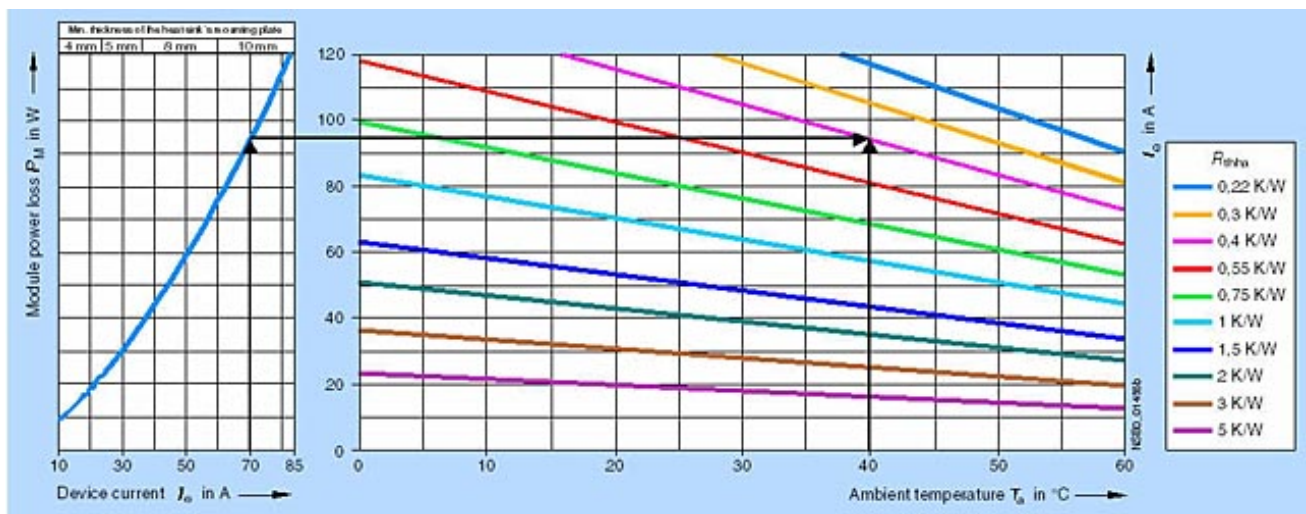

last change:

10/31/2006

**Technical Assistance:**

Telephone: +49 (0) 911-895-5900 (8° - 17° CET)

Fax: +49 (0) 911-895-5907

E-Mail: [technical-assistance@siemens.com](mailto:technical-assistance@siemens.com)Internet: [www.siemens.de/lowvoltage/technical-assistance](http://www.siemens.de/lowvoltage/technical-assistance)