

### Construction and working characteristics

- 3-way valve with double poppet.
- Possibility to adjust the down stream circuit filling time by the enclosed adjustable metering screw.
- Quick down stream circuit discharge.
- Possibility for a pneumatic or electric piloting control.
- Body made with anodized 2011 aluminum alloy.
- Wall mounting possibility with M5 screws.

### Technical characteristics

Connections	G 3/8"
Max. inlet pressure	10 bar - 1 MPa
Max. ambient temperature	50°C
Weight	gr. 595
Assembly position	Any
Wall mounting screws	M5
Nominal flow at 6 bar with $\Delta p=1$	1700 NI/min.
Flow with adjustable metering screw fully open	340 NI/min

**Important note:** the preventive or programmed maintenance of this product is not foreseen considering the elaborated assembling and the specific "PNEUMAX" testing; therefore, call the producer or its representative in case of necessity.

Ordering code

### 17210.M2

Electrically controlled progressive start-up valve size 2, complete with mechanic for M2 microsolenoid valve.

### 17220

Progressive start-up valve size 2 with pneumatic control.

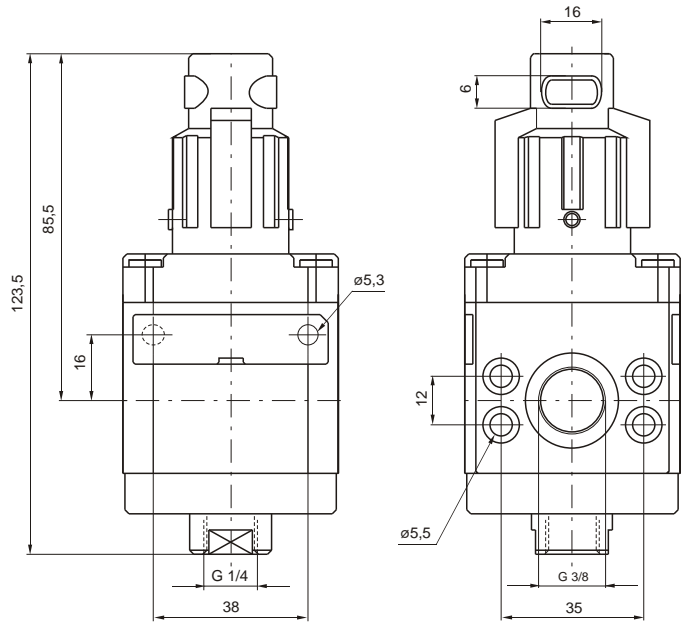

2

**Construction and working characteristics**

- 3 ways poppet valve.
- Body made with anodized aluminum alloy 2011.
- Wall mounting possibility with M5 screws protected by covers.
- Double handle action for valve opening: pushing and rotating (clockwise).
- Simple rotate the valve handle counter clockwise for valve closing and down stream circuit discharging.
- Possibility to lock the valve in the discharging position by fitting in a padlock in the proper seat.

**Important note:** the preventive or programmed maintenance of this product is not foreseen considering the elaborated assembling and the specific "PNEUMAX" testing; therefore, call the producer or its representative in case of necessity.

**Technical characteristics**

Connections	G 3/8"
Max. inlet pressure	13 bar - 1.3 MPa
Max. ambient temperature	50°C
Weight	gr. 380
Assembly position	Any
Nominal flow at 6 bar with $\eta_p=1$	2100 NI/min.
Wall mounting screws	M5
Handle opening and closing angle	90°
Max. fitting torque	25 Nm

Ordering code

**17230 .**

A = Not lockable handle  
B = Lockable handle

Example: **17230.B**  
Shut-off valves size 2 complete with lockable handle.