



CONTACTOR SIZE 14, 3-POLE AC-3, 335KW,
400/380V (690V) AUXILIARY CONTACTS 44 (4NO+4NC)
AC OPERATION AC 200 TO 240V 50/60HZ

General details:

Size of the contactor		14
Protection class IP / on the front		IP00
Ambient temperature / during operating	°C	55 ... -25
Item designation / according to DIN 40719 extendable after IEC 204-2 / according to IEC 750		K
Item designation / according to DIN EN 61346-2		Q

Main circuit:

Number of poles / for main current circuit		3
Operating current / at AC-1 / at 400 V		
• at 40 °C ambient temperature / rated value	A	700
Number of NC contacts / for main contacts		0
Number of NO contacts / for main contacts		3
Operating current / at AC-3 / at 400 V / rated value	A	630
Service power		
• at AC-3 / at 400 V / rated value	kW	335
• at AC-1 / at 400 V / rated value	kW	415

Control circuit:

Design of activation / of the operating mechanism		conventional
---	--	--------------

Type of voltage / of the controlled supply voltage		AC
Control supply voltage frequency		
• 1 / rated value	Hz	50
• 2 / rated value	Hz	60
Control supply voltage		
• at 50 Hz / at AC		
• rated value	V	200 ... 240
• at 60 Hz / at AC		
• rated value	V	200 ... 240

Auxiliary circuit:

Number of NC contacts / for auxiliary contacts		
• lagging switching		0
• instantaneous switching		4
Number of NO contacts / for auxiliary contacts		
• leading switching		0
• instantaneous switching		4

Connection type:

Design of the electrical connection		
• for main current circuit		screw-type terminals
• for auxiliary and control current circuit		screw-type terminals
Identification number and letter for switching elements		44

Mechanical design:

Type of mounting		screw fixing
Type of fixing/fixation / series installation		Yes
Width	mm	230
Height	mm	232
Depth	mm	237

Certificates/approvals:

General Product Approval

Functional Safety /
Safety of
Machinery



CCC



CSA



UL



UR

[Type Examination](#)

Declaration of
Conformity

Test Certificates



EG-Konf.

[Special Test
Certificate](#)

[Type Test
Certificates/Test
Report](#)

Shipping Approval



GL



LRS



PRS



RMRS

other

[Declaration of
Conformity](#)

[other](#)

[Environmental
Confirmations](#)

Further information:

Information- and Downloadcenter (Catalogs, Brochures,...)

<http://www.siemens.com/industrial-controls/catalogs>

Industry Mall (Online ordering system)

<http://www.siemens.com/industrial-controls/mall>

Cax online generator:

<http://www.siemens.com/cax>

Service&Support (Manuals, Certificates, Characteristics, FAQs,...)

<http://support.automation.siemens.com/VW/view/en/3TF6844-0CM7/all>

Image database (product images, 2D dimension drawings, 3D models, device circuit diagrams, ...)

http://www.automation.siemens.com/bilddb/cax_en.aspx?mlfb=3TF6844-0CM7

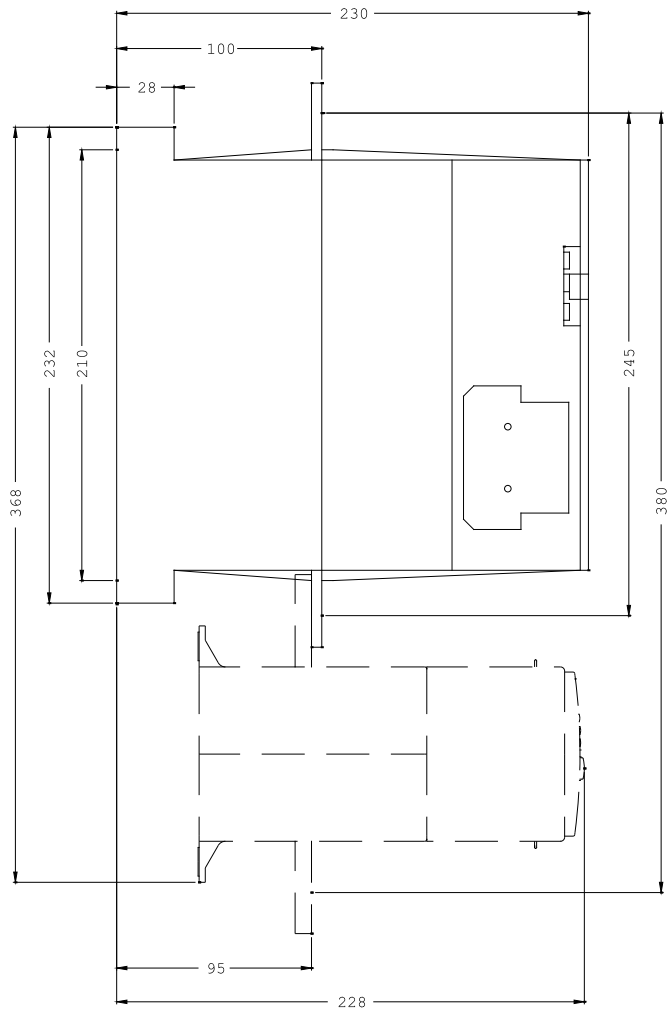
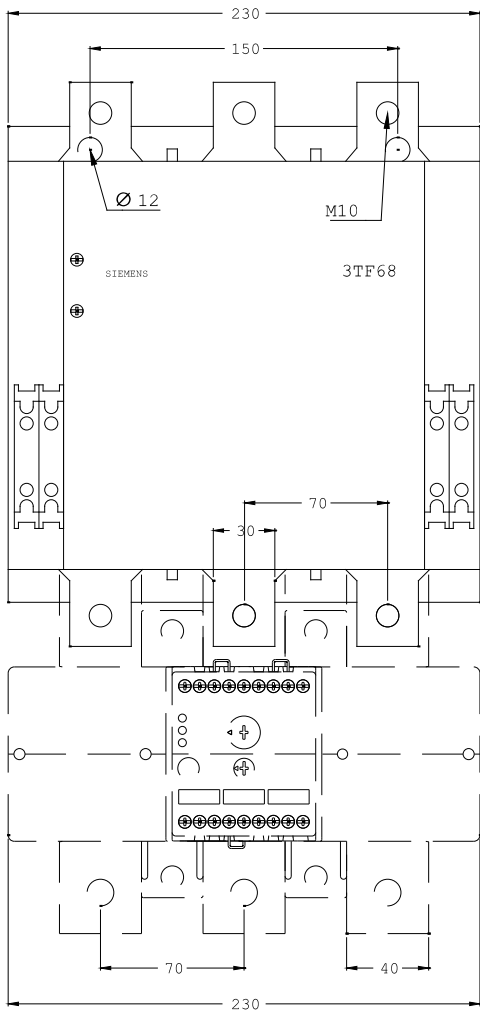

last change:

Oct 28, 2013