

DD0001

D100/230VAC

Evaluation systems, power supplies

no longer available - archive entry

replaced by: DD0203

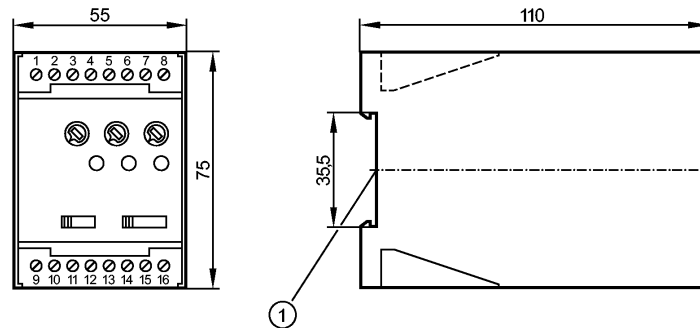

1: Mounting on DIN rail



Product characteristics

Speed monitor

D100

Housing for DIN rail mounting

Application

| | |
|--------------------|--|
| Application | evaluation of pulse sequences with regard to overspeed and underspeed; rotational speed monitoring |
| Switching function | F1-F4, with 4-step slide switch |
| Switching output | relay (1 changeover contact) |

Electrical data

| | | |
|-------------------|-----|-----------------------------|
| Nominal voltage | [V] | 230 AC (50...60 Hz) / 24 DC |
| Voltage tolerance | [%] | ± 10 |
| Sensor supply | [V] | 24 DC (max. 30mA) |

Inputs

| | |
|-------------------------------------|----------------|
| Digital | 1 |
| Input frequency (max.) [pulses/min] | 15000 (250 Hz) |

Outputs

| | |
|----------------|--------------------------|
| Relay | 1 |
| Relay | 1 |
| Contact rating | 8 A / 1250 VA / 250 V AC |

Measuring / setting range

| | | |
|--------------------------------|---------------|--|
| Setting range | [pulses/min.] | 5...5000 |
| Adjustment of the switch point | | 3 ranges preselectable, fine adjustment with potentiometer |
| Hysteresis | [% of Sp] | 5...100 |
| Start-up delay | [s] | 0.5...15 |

Accuracy / deviations

| | | |
|---------------|----------|---|
| Repeatability | [% / Sp] | 1 |
|---------------|----------|---|

Environment

| | | |
|--------------------------------|------|---------------|
| Ambient temperature | [°C] | -20...70 |
| Protection housing / terminals | | IP 40 / IP 20 |

Safety classification

| | | |
|------|-----|-----|
| MTTF | [a] | 468 |
|------|-----|-----|

DD0001

D100/230VAC

Evaluation systems, power supplies

| Mechanical data | |
|--|---|
| Housing materials | plastics |
| Weight [kg] | 0.42 |
| Displays / operating elements | |
| Operation LED | green |
| Input pulses LED | yellow |
| Output status indication LED | green (lights when the output relay is energised) |
| Electrical connection | |
| Connection | 16 terminals...2.5 mm ² |
| Wiring 01: n.c. 02: n.c. 03: DC Sensor supply (-) 04: sensor signal pnp 05: DC Sensor supply (+) 06: DC Supply voltage (-) 07: DC Supply voltage (+) 08: n.c. 09: n.c. 10: n.c. 11: n.c. 12: Relay (normally closed) 13: Relay (common) 14: Relay (normally open) 15: AC Supply voltage (L) 16: AC Supply voltage (N) n.c. = not connected | <p>The diagram shows two vertical terminal blocks. The left block has terminals 1 to 8. Terminal 7 is labeled 'DC ⊕' and terminal 6 is 'DC ⊖'. Terminal 5 is '⊕' and terminal 4 is '⊖'. Terminal 3 is '⊖'. A DC supply symbol is connected to terminals 5, 4, and 3. The right block has terminals 9 to 16. Terminal 16 is 'N AC' and terminal 15 is 'L1 AC'. Relay contacts are shown: terminal 12 is connected to terminal 14, and terminal 13 is connected to terminal 14.</p> |
| Remarks | |
| Pack quantity [piece] | 1 |

ifm electronic gmbh • Friedrichstraße 1 • 45128 Essen — We reserve the right to make technical alterations without prior notice. — GB — DD0001 — 04.12.2014

no longer available - archive entry

replaced by: DD0203